

DISTANZIATORI A DOPPIO INNESTO RAPIDO FORO DI Ø 4,0 - Ø 5,0



Descrizione tecnica

Materiale: PA 6.6

Colore: nero

Autoestinguenza: V2 (UL 94)

Temperatura esercizio: -35°C ~ +130°C

Tutte le quote sono in mm

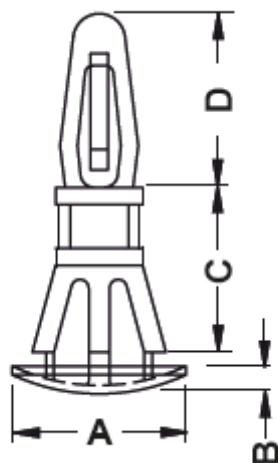

Codice	A	B	C	D	Foro superiore	Spessore sup.	Foro inferiore	Spessore inf.	Conf./pezzi
10006AA0104.0	9,0	1,5	4,0	9,8	Ø 4,0	0,6	Ø 5,0	1,0	500
10006AA0105.0	9,0	1,5	5,0	9,8	Ø 4,0	0,6	Ø 5,0	1,0	500
10006AA0106.0	9,0	1,5	6,0	9,8	Ø 4,0	0,6	Ø 5,0	1,0	500
10006AA0107.0	9,0	1,5	7,0	9,8	Ø 4,0	0,6	Ø 5,0	1,0	500
10006AA0108.0	9,0	1,5	8,0	9,8	Ø 4,0	0,6	Ø 5,0	1,0	500

Codice	A	B	C	D	Foro superiore	Spessore sup.	Foro inferiore	Spessore inf.	Conf./pezzi
10006AA0109.0	9,0	1,5	9,0	9,8	Ø 4,0	0,6	Ø 5,0	1,0	500
10006AA0110.0	9,0	1,5	10,0	9,8	Ø 4,0	0,6	Ø 5,0	1,0	500
10006AA0111.0	9,0	1,5	11,0	9,8	Ø 4,0	0,6	Ø 5,0	1,0	500
10006AA0112.0	9,0	1,5	12,0	9,8	Ø 4,0	0,6	Ø 5,0	1,0	500
10006AA0113.0	9,0	1,5	13,0	9,8	Ø 4,0	0,6	Ø 5,0	1,0	500
10006AA0114.0	9,0	1,5	14,0	9,8	Ø 4,0	0,6	Ø 5,0	1,0	500
10006AA0115.0	9,0	1,5	15,0	9,8	Ø 4,0	0,6	Ø 5,0	1,0	500
10006AA0116.0	9,0	1,5	16,0	9,8	Ø 4,0	0,6	Ø 5,0	1,0	500
10006AA0117.0	9,0	1,5	17,0	9,8	Ø 4,0	0,6	Ø 5,0	1,0	500
10006AA0118.0	9,0	1,5	18,0	9,8	Ø 4,0	0,6	Ø 5,0	1,0	500
10006AA0119.0	9,0	1,5	19,0	9,8	Ø 4,0	0,6	Ø 5,0	1,0	500
10006AA0120.0	9,0	1,5	20,0	9,8	Ø 4,0	0,6	Ø 5,0	1,0	500
10006AA0121.0	9,0	1,5	21,0	9,8	Ø 4,0	0,6	Ø 5,0	1,0	500
10006AA0122.0	9,0	1,5	22,0	9,8	Ø 4,0	0,6	Ø 5,0	1,0	500
10006AA0123.0	9,0	1,5	23,0	9,8	Ø 4,0	0,6	Ø 5,0	1,0	500
10006AA0124.0	9,0	1,5	24,0	9,8	Ø 4,0	0,6	Ø 5,0	1,0	500
10006AA0125.0	9,0	1,5	25,0	9,8	Ø 4,0	0,6	Ø 5,0	1,0	500
10006AA0126.0	9,0	1,5	26,0	9,8	Ø 4,0	0,6	Ø 5,0	1,0	500
10006AA0127.0	9,0	1,5	27,0	9,8	Ø 4,0	0,6	Ø 5,0	1,0	500
10006AA0128.0	9,0	1,5	28,0	9,8	Ø 4,0	0,6	Ø 5,0	1,0	500
10006AA0129.0	9,0	1,5	29,0	9,8	Ø 4,0	0,6	Ø 5,0	1,0	500
10006AA0130.0	9,0	1,5	30,0	9,8	Ø 4,0	0,6	Ø 5,0	1,0	500
10006AA0131.0	9,0	1,5	31,0	9,8	Ø 4,0	0,6	Ø 5,0	1,0	500
10006AA0132.0	9,0	1,5	32,0	9,8	Ø 4,0	0,6	Ø 5,0	1,0	500
10006AA0133.0	9,0	1,5	33,0	9,8	Ø 4,0	0,6	Ø 5,0	1,0	500
10006AA0134.0	9,0	1,5	34,0	9,8	Ø 4,0	0,6	Ø 5,0	1,0	500
10006AA0135.0	9,0	1,5	35,0	9,8	Ø 4,0	0,6	Ø 5,0	1,0	500
10006AA0136.0	9,0	1,5	36,0	9,8	Ø 4,0	0,6	Ø 5,0	1,0	500