

TORNILLO DE CABEZA MOLETEADA



Descripción Técnica

Material: PA66 + 25% FV

Color: Negro y Blanco

Autoestinguibilidad: UL94-HB

Temperatura de trabajo: -35°C ~ +100°C

Todas las medidas están indicadas en mm

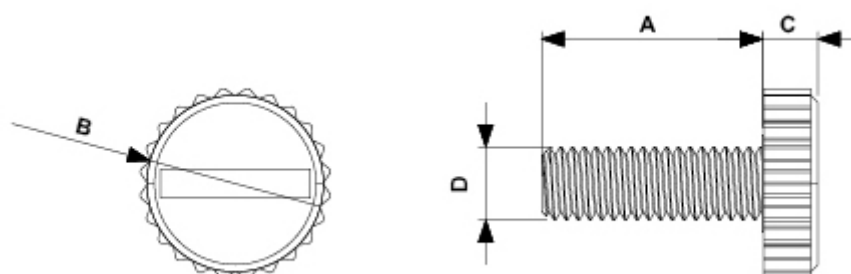

Codigo	A	B	C	D	Notas	Conf./piezas
0572BB01	6,0	13,0	3,8	M 4x0,7	Fornibile in bianco / White color available	1.000
0573BB01	10,0	13,0	3,8	M 4x0,7	Fornibile in bianco / White color available	1.000
0574BB01	15,0	13,0	3,8	M 4x0,7	Fornibile in bianco / White color available	1.000
0575BB01	20,0	13,0	3,8	M 4x0,7	Fornibile in bianco / White color available	1.000
0582BB01	10,0	13,0	3,8	M 5x0,8	Fornibile in bianco / White color available	1.000
0583BB01	15,0	13,0	3,8	M 5x0,8	Fornibile in bianco / White color available	1.000
0584BB01	20,0	13,0	3,8	M 5x0,8	Fornibile in bianco / White color available	1.000
0588BB01	10,0	13,0	3,8	M 6x1	Fornibile in bianco / White color available	1.000

Codigo	A	B	C	D	Notas	Conf./piezas
0589BB01	15,0	13,0	3,8	M 6x1	Fornibile in bianco / White color available	1.000
0590BB01	20,0	13,0	3,8	M 6x1	Fornibile in bianco / White color available	1.000