

TACT SWITCH CAP



Technical description

Material: ABS

Colour: black

Flammability: HB (UL94)

Working temperature:

-30°C ~ +90°C

All dimensions are in mm

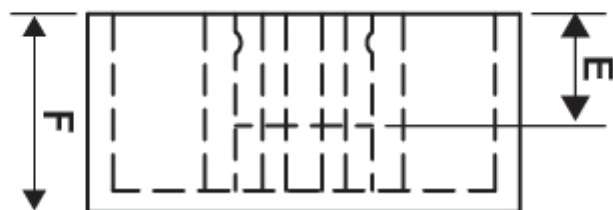
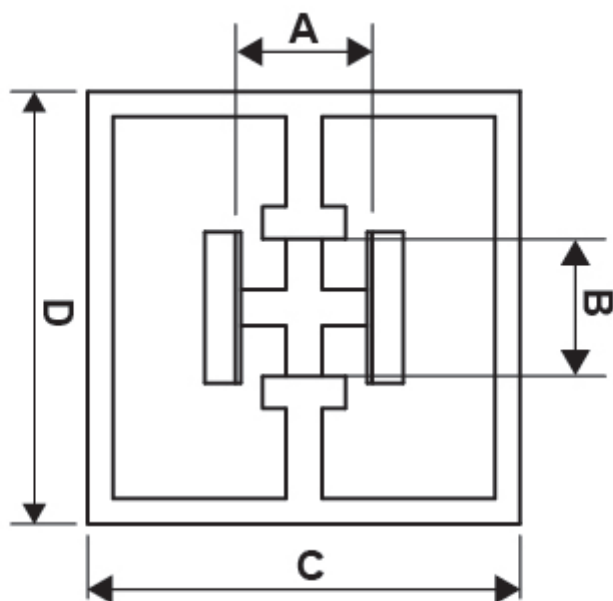

Code	A	B	C	D	E	F	MOQ-Pcs
5655HA01	3,8	3,8	12,0	12,0	3,1	55,0	1.000