

POLICARBONATE INSULATED DOUBLE CRIMP PIN TERMINALS



Technical description

Terminal material: CU-ETP 99.9% tin-plated copper

Isolation: Polycarbonate PC

Colour: See table

Rated voltage: 600V max.

Working temperature: 125°C max.

All dimensions are in mm.

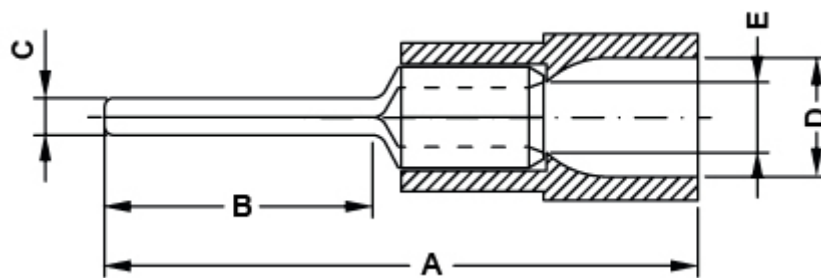

Code	A	B	C	D	E	Size	Colour	MOQ-Pcs
16514NA08	22,8	12,0	1,9	4,5	2,3	1,5 - 2,5	Blu / Blue / Blau	100

Code	A	B	C	D	E	Size	Colour	MOQ-Pcs
16515NA08	27,0	16,0	1,9	4,5	2,3	1,5 - 2,5	Blu / Blue / Blau	100
16521NA06	27,0	14,0	2,8	6,4	3,6	4,0 - 6,0	Giallo - Yellow - Gelb	100
16533NA04	22,8	12,0	1,9	4,0	1,7	0,5 - 1,5	Rosso - Red - Rot	100