

## EDGE CABLE BUSHING



### Technical description

**Material:** PA 6.6

**Colour:** Natural

**Flammability:** V2 (UL94)

**Working temperature:** -35°C ~ +85°C

All dimensions are in mm

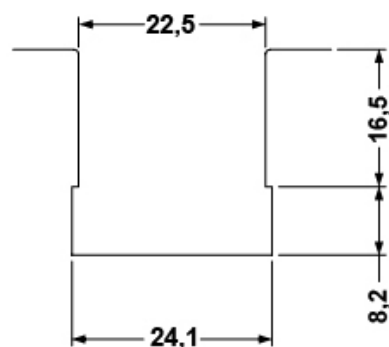
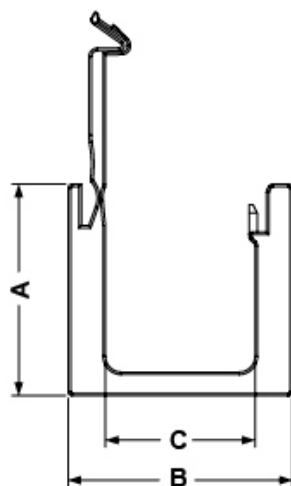
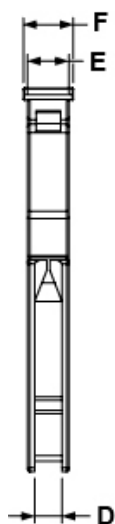

**FORO DI MONTAGGIO**  
**MONTAGE AUSSPARUNG**  
**MOUNTING HOLE**

Code	A	B	C	D	E	F	Thickness	MOQ-Pcs
13181AA00	25,5	27,0	18,0	3,3	5,0	6,0	0,8 - 3,0	1.000