

## BRASS METRIC LOCKNUTS



### Technical description

**Material:** Nickel-plated brass

**Working temperature:** -60°C ~ +200°C

Metric as per EN 60423

All dimensions are in mm.

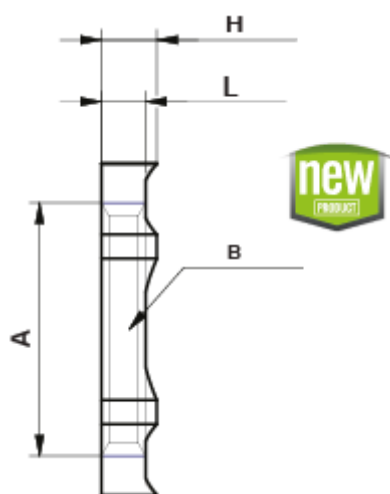

Code	A	B	H	L	MOQ-Pcs
18501MA92	M16x1,5	19,0	3,5	2,8	100
17943MA92	M20x1,5	24,0	3,7	3,0	100
18502MA92	M25x1,5	30,0	4,2	3,5	100
18582MA92	M32x1,5	36,0	4,7	4,0	100
18583MA92	M40x1,5	46,0	5,7	5,0	50
18584MA92	M50x1,5	60,0	5,7	5,0	50
18585MA92	M63x1,5	70,0	6,7	6,0	50